

Shuttering Magnet Technical Parameter Update

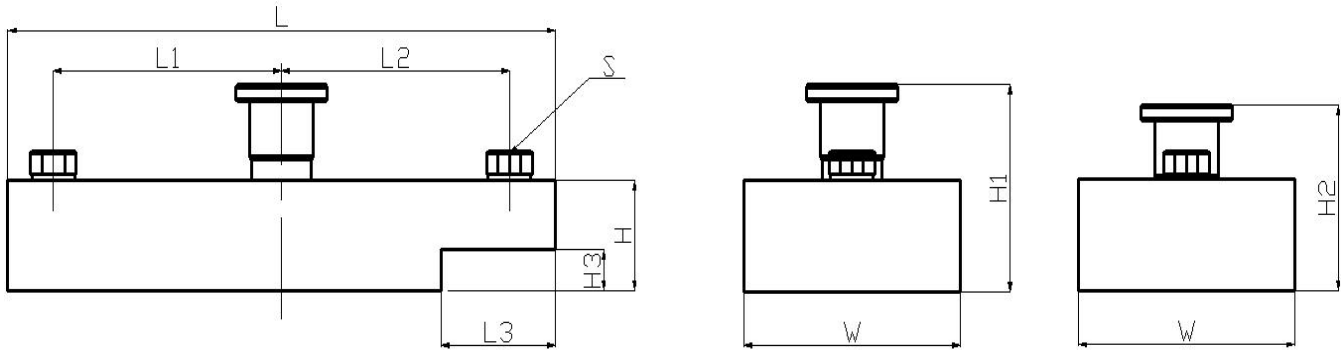

Item	L	W	H	L1	L2	L3	H1	H2	H3	S	
Kg	mm	mm	mm	mm	mm	mm	mm	mm	mm		
450	170	60	40	67.5	67.5	\	73	66.5	\	M12	
600	170	60	40	67.5	67.5	\	73	66.5	\	M12	
600-Step	200	60	40	72.5	97.5	42	73	66.5	10	M12	
800	190	95	43	67	93	50	80	73.5	10	M12	
900	280	60	40	122	122	\	73	66.5	\	M12	
900-Step	195	95	43	67	98	50	80	73.5	10	M12	
1000	200	95	43	67	100	50	80	73.5	10	M12	
1350A	320	90	60	135	135	\	98	90	\	M16	
1350-Step	320	90	60	113	161	47	98	90	\	M16	
1300	210	95	45	80	90	40	73	65	\	M16	
1600	270	120	60	110	110	\	98	90	\	M16	
1800	320	120	60	135	135	\	98	90	\	M16	
2100	320	120	60	135	135	\	98	90	\	M16	
2400	320	120	60	135	135	\	98	90	\	M16	
2600	320	120	60	135	135	\	98	90	\	M16	

with Step:



Without Step:

